

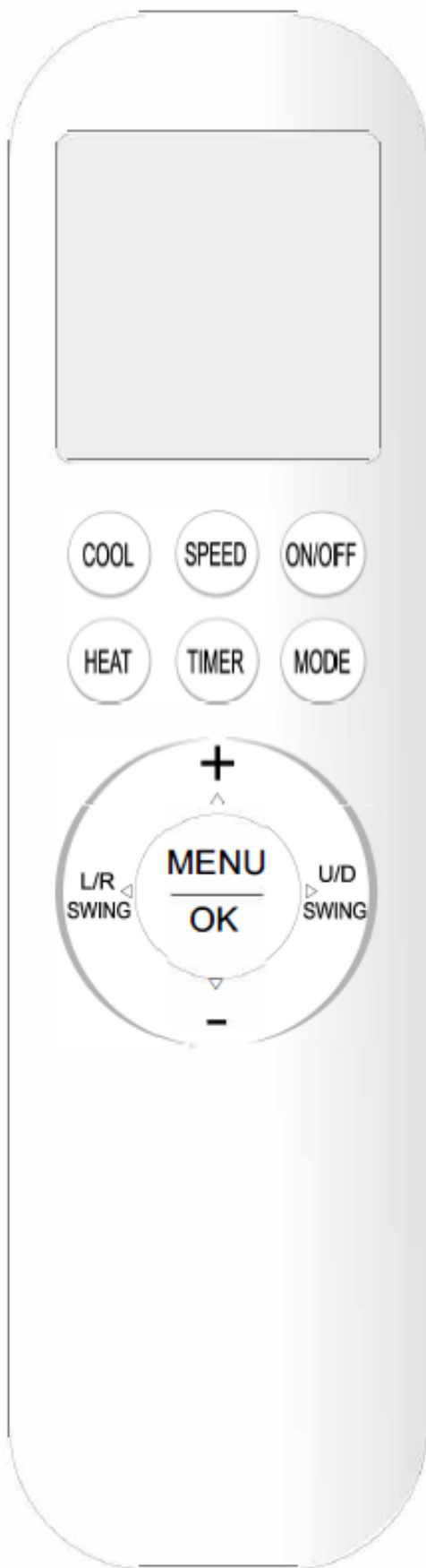

R32 WALL-MOUNTED AIR HANDLER REMOTE CONTROLLER USER MANUAL

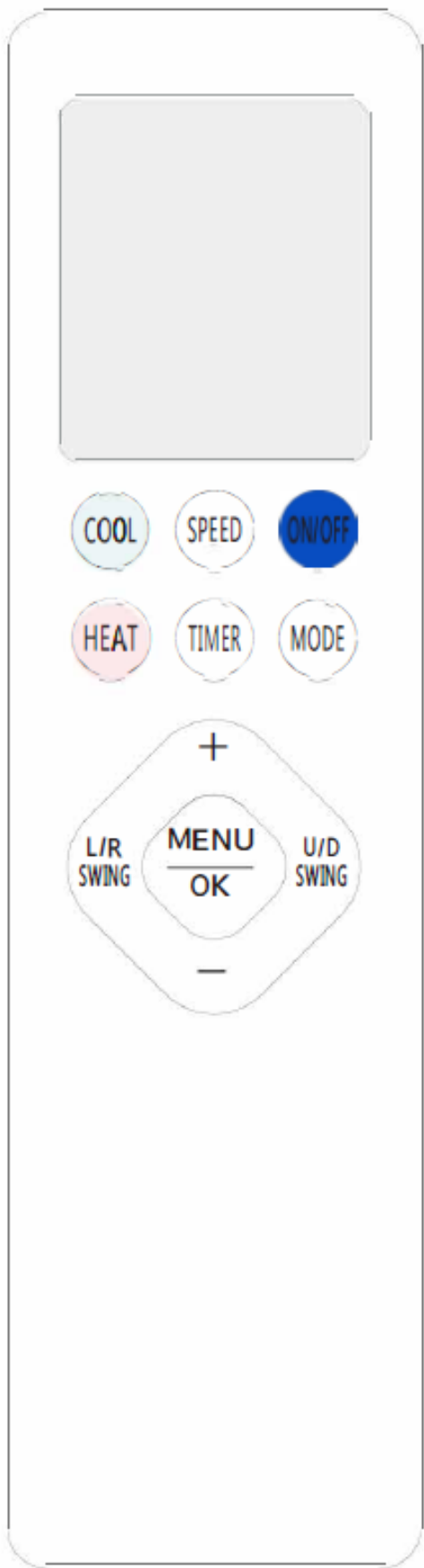

- Carefully read the instructions for safe and correct use of the air-conditioner.
- Carefully keep the instructions as it can be referred to at any time.

Precautions

- Before first time use of the remote controller, install the batteries and ensure the “+” and “-” poles are correctly positioned.
- Ensure the remote controller is pointed to the signal receiving window and that there is no obstruction between them, the distance is 8m at the maximum.
- Do not let the remote controller drop or fling it at will.
Do not let any liquid in the remote controller.
Do not expose the remote controller directly to the sunlight or excessive heat.
- If the remote controller does not function normally, remove the batteries for 30 seconds before reinstall them. If that doesn't work, replace the batteries.
- When replacing the batteries, do not mix the new batteries with old ones or mix batteries of different types, which could cause failure of the remote controller.
- If the remote controller is not to be used for a long period of time, remove the batteries first, lest the leakage from them may damage the remote controller.
- Properly dispose the discarded batteries.

Note:

- 1. This is an universal remote controller which provide all the function buttons. Please understand that some of the buttons may not function, depending on the specific air conditioner you have purchased. (If a specific function is not available on the air conditioner, pressing the corresponding button will simply have no respond.)**
- 2. HEAT and ELE. H functions are not available for single cooling model, thus these two buttons do not work correspondingly.**

Buttons Description

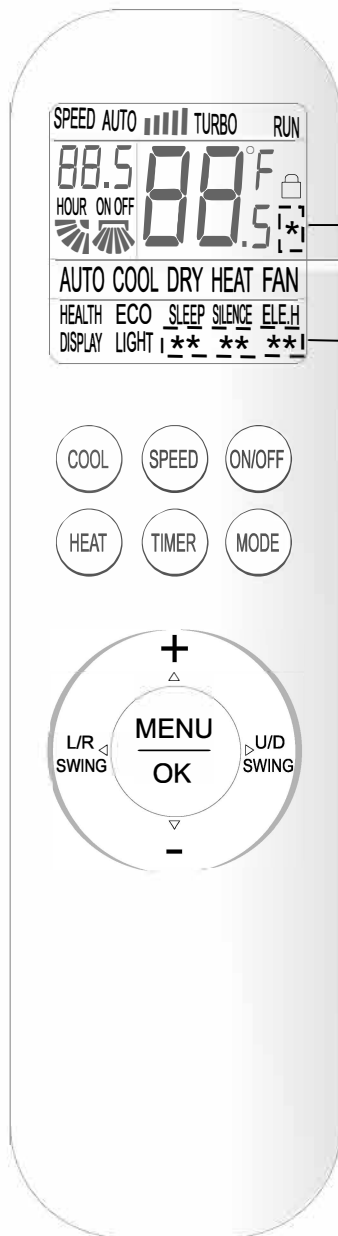
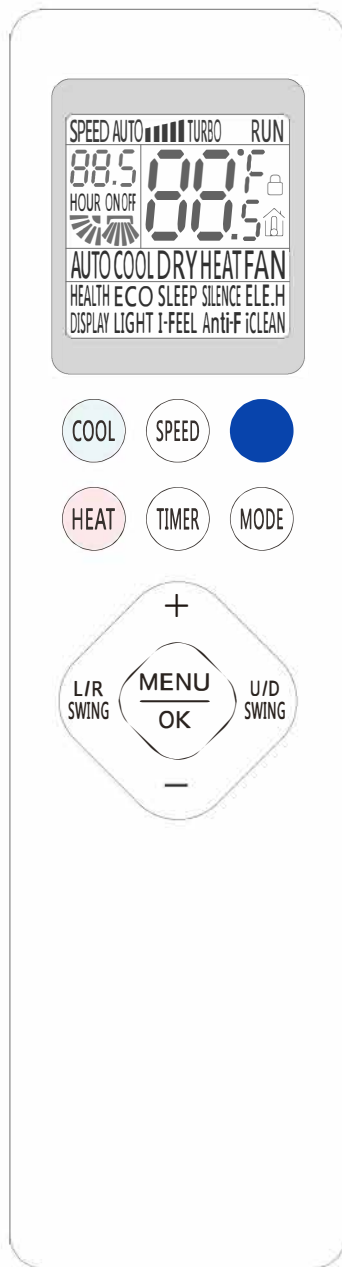

- **Type: A**
shown as %
- **Type: B**
shown as

- **Type: A**
shown as COSY HUMI iCLEAN
- **Type: B**
shown as I-FEEL Anti-F iCLEAN

Note:

1. There are two different display types of remote control (type A and type B) , whichever is the actual type.

2. The remote controller display all symbols during power-on, other time only display symbols corresponding to current operation.

1. ON/OFF Button

* Press this button to turn on/off the unit.

2. MODE Button

* Press this button, you can select operation mode as follows:

→ AUTO → COOL → DRY → HEAT → FAN →

Note: Heat mode is not available for cool only unit.

Please read the Usage for Mode for a detailed description.

3. TIMER Button

- * With the unit on, press this button to set off timer or with it off to set on timer.
- * Press this button once, the “ON(OFF)” will flash. Press “ + ” or “ – ” to set the number of hours in which the unit will be turned on/off, with an interval of 0.5 hour, and a range of 0.5-24 hours.
- * Press it again to confirm the setting, the “ON (OFF)” will stop flashing.
- * If the “TIMER” or “+” or “-” button is not pressed within 10 seconds after the “ON/OFF” character start flashing, the TIMER setting will be exited.
- * If a timer setting is confirmed, press this button again will cancel it.

4. HEAT Button

- * Press this button to enter “HEAT” mode.

5. COOL Button

- * Press this button to enter “COOL” mode.

6. SPEED Button

- * Press this button, you can select fan speed as follows:

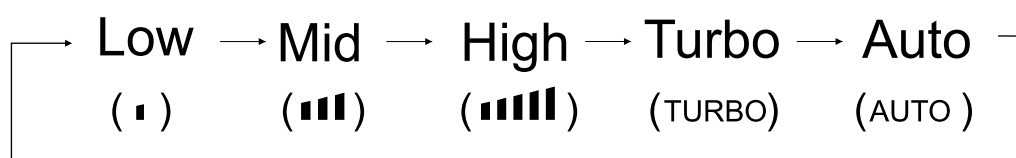

Note: Auto air speed is not available in fan mode.
Turbo is only effective in heating or cooling mode.
In Dry mode, the fan speed is forcibly set to low.

7. + & - Button

- * Each time the “ + ” is pressed, the temperature setting will increase by 1°C(1°F) and each time the “ – ” is pressed, it will decrease by 1°C(1°F).
- * The temperature setting range: 16°C (60°F) ~ 32°C(90°F).

Note: The temperature cannot be set in fan mode.

8. MENU & OK Button

- * Press the “MENU” button to enter the function selection mode.
Then press \triangle (+), ∇ (-), \triangleleft (L/R SWING) and \triangleright (U/D SWING) to choose the function which you want. After, press the “OK” button, turn on this function.
- * In function selection mode, press \triangle (+), ∇ (-), \triangleleft (L/R SWING) and \triangleright (U/D SWING), the character in LCD will be flashing if the function can be selected.

9. L/R SWING Button

- * Press this button to activate left/right swing and press it again to turn off the swing function.

10. U/D SWING Button

- * Press this button to activate up/down swing and press it again to turn off the swing function.

Note:

- * When the unit is on, press the “U/D SWING” button and hold for 3 seconds, the button will shift to be the functional button of “Rated swinging”, and then press the “U/D SWING” button to select the positions of Rated swinging.
- * Only by pressing the “U/D SWING” button again and hold for 3 seconds or reinstall the battery of the remote control, can the “U/D SWING” button resume its original function. The power on/off button of the remote control can not enable the exit of the “Rated swinging” function.

11. HEALTH function

- * When the unit is on, press the “MENU” button, then press \triangle (+), ∇ (-), \triangleleft (L/R SWING) and \triangleright (U/D SWING) to choose “HEALTH” character, when the “HEALTH” character will blink, and press the “OK” button to highlight (not highlight) the “HEALTH” character, which will activate (deactivate) the health function.

12.ECO function

- * When the air conditioner is on and in the COOL mode, press the “MENU” button, then press $\triangle(+)$, $\nabla(-)$, $\triangleleft(\text{L/R SWING})$ and $\triangleright(\text{U/D SWING})$ to choose the “ECO” character, when the “ECO” character will blink, and press the “OK” button to highlight(not highlight) the “ECO” function. The variable frequency air conditioner will enter the ECO function, which consumes the least electricity, and will automatically exit after 8 hours.
- * The ECO function is not available on fixed frequency air conditioners.
- * Changing modes or turning off the air conditioner will automatically cancel the ECO function.

Note: The electricity consumption is affected by the ambient temperature and the house structure etc., and when the ambient temperature is high or the house has a large area, be cautious to use the ECO mode.

13.SLEEP function

- * When the unit is on, press the “MENU” button, then press $\triangle(+)$, $\nabla(-)$, $\triangleleft(\text{L/R SWING})$ and $\triangleright(\text{U/D SWING})$ to choose the “SLEEP” character, when the “SLEEP” character will blink, and press the “OK” button to highlight (not highlight) the “SLEEP” character , which will activate (deactivate) the function of sleep mode.
- * The unit will exit SLEEP mode after 10 hours of continuous operation and restore to the previous status.

Note: The sleep function cannot be activated in fan or auto mode. In the sleep mode, the screen of the air-conditioner is off.

14.SILENCE function

- * When the unit is on, press the “MENU” button, then press $\triangle(+)$, $\nabla(-)$, $\triangleleft(\text{L/R SWING})$ and $\triangleright(\text{U/D SWING})$ to choose the “SILENCE” character, when the “SILENCE” character will blink, and press the “OK” button to highlight (not highlight) the “SILENCE” character , which will activate (deactivate) the function of silent wind.

15.ELE.H function

- * When the air conditioner is on and in the HEAT mode, press the “MENU” button, then press Δ (+), ∇ (-), \triangleleft (L/R SWING) and \triangleright (U/D SWING) to choose the “ELE.H” character, when the “ELE.H” character blinks, and press the “OK” button to highlight (not highlight) the “ELE.H” character, which will activate (deactivate) the function of auxiliary heating.
- * In Heating Mode, the ELE.H function is enabled by default
- * ELE.H function is not available for single cool models.

16.DISPLAY function

- * Press the “MENU” button, then press Δ (+), ∇ (-), \triangleleft (L/R SWING) and \triangleright (U/D SWING) to choose the “DISPLAY” character, when the character “DISPLAY” will blink, and press the “OK” button to activate (deactivate) the function of screen display.

17.LIGHT function

- * The unit will activate or deactivate automatically the function of display on the air-conditioner screen according to the indoor ambient brightness.
- * When the unit is on, press the “MENU” button, then press Δ (+), ∇ (-), \triangleleft (L/R SWING) and \triangleright (U/D SWING) to choose the “LIGHT” character, when the “LIGHT” character will blink, and press the “OK” button to highlight (not highlight) the character “LIGHT”, which will activate (deactivate) the function of light sensing.

18.COSY function (Only Type A)

- * When the air-conditioner is on under the modes of cooling, press the “MENU” button, then press Δ (+), ∇ (-), \triangleleft (L/R SWING) and \triangleright (U/D SWING) to choose the “COSY” character, when the “COSY” character will blink, and press the “OK” button to highlight (no highlight) the character “COSY”, which will activate (deactivate) the function of cleaning.
- * When the “COSY” function is on, the fan speed is auto and it will cancel the swinging function.
When the “COSY” function is on, these operations that turn off the unit, change the mode, and set SLEEP, fan speed, swinging function will automatically exit the “COSY” function, then restore to the previous status.

19.HUMI function (Only Type A)

- * Press the “MENU” button, then press $\triangle(+)$, $\nabla(-)$, \triangleleft (L/R SWING) and \triangleright (U/D SWING) to choose the “HUMI” character, when the “HUMI” character will blink, and press the “OK” button to highlight (not highlight) the “HUMI” character, which will activate (deactivate) the humidifying function .

Note: The humidifying function is not available under the dry mode.

20.iCLEAN function

- * The unit will clean automatically the dust on the evaporator and dry or blow-dry the moisture.
- * When the air-conditioner is off, press the “MENU” button, then press $\triangle(+)$, $\nabla(-)$, \triangleleft (L/R SWING) and \triangleright (U/D SWING) to choose the “iCLEAN” character, when the “iCLEAN” character will blink, and press the “OK” button to highlight (not highlight) the character “iCLEAN”, which will activate (deactivate) the function of cleaning.
- * The cleaning function will close automatically within 30~60 minutes.

21.Child-lock function

- * Press the “HEAT” and “MODE” buttons at the same time and hold for at least 3 seconds to activate or deactivate the child-lock function.
- * When the child-lock function is activated, the remote control will indicate “”.

22.Anti-F function (Only Type B)

- * Anti-F function: When the unit is closed under the modes of cooling, dry or auto (cooling), it will continue to operate for about 3 minutes to dry the moisture on the evaporator, so as to prevent the accumulation of bacteria on the evaporator, which causes fungus and strange smell and is harmful to the health.
- * When the unit is off, press the “MENU” button, then press $\triangle(+)$, $\nabla(-)$, \triangleleft (L/R SWING) and \triangleright (U/D SWING) to choose the “Anti-F” character, when the “Anti-F” character will blink, and press the “OK” button to highlight (not highlight) the “Anti-F” character, which will activate (deactivate) the Anti-F function.

23.I-FEEL function (Only Type B)

- * When the unit is on, press the “MENU” button, then press \triangle (+), ∇ (-), \triangleleft (L/R SWING) and \triangleright (U/D SWING) to choose the “I-FEEL” character, when the “I-FEEL” character will blink, and press the “OK” button to highlight (not highlight) the “I-FEEL” and “” character , which will activate (deactivate) the I-FEEL function .

Note: When the I-FEEL function is turned on, the remote control will periodically send temperature signals to the machine. When using this function, the remote control transmitter must be aimed at the machine.

24.°C/°F function

- * The default display unit for temperature is based on the actual product.
- * Press the “COOL” and “HEAT” buttons at the same time above 3 seconds, you can set the “ °C ”or “ °F ”.

Note: Temperature display in Fahrenheit is not available for some models. When temperature is displayed in Fahrenheit on the remote controller, it might be in Celsius on the unit, the function and operation of which will not be affected.

25. 8°C(46°F) heating function

- * Only in the heating mode in the power-on state, press the “MODE” and “+” buttons at the same time above 3 seconds to turn on or off the 8°C(46°F)heating function.
- * After turning on the 8°C(46°F)heating function:
 - a. Press the “HEAT” button, or switch to mode, or select the sleep function, all can exit 8°C(46°F)heating function.
 - b. Press the “SPEED”, “+”, “-” button is all non-effective.
 - c. Fahrenheit/Celsius switching function is non-effective.
 - d. Turn off and on the unit again, 8°C(46°F)heating function is still retained.
 - e. Press the “MENU” button, ELE.H function is not selectable.

26. Temperature setting function:

1. Function only available on some models;
2. In the shutdown state, press the “Cool” button and the “Mode” button at the same time for 10 seconds or more, the maximum temperature setting value (32 °C /90 F) will be displayed, and the “H” will flash, press the [+/-] key to adjust the range, and press the “Mode” key to confirm. The minimum temperature setting (16 °C /60 °F) is displayed, and the “L” flashes. Press the [+/-] button to adjust the minimum temperature range. Press “Mode” to confirm, then the setting is complete;
3. You need to reset after replacing the battery.

★ Auto operation mode

1. Press the “ON/OFF” button, the air-conditioner starts to operate.
2. Press the “MODE” button, select auto operation mode.
3. By pressing the “SPEED” button, you can select fan speed from Low, Mid, High, Auto.
4. Press the “ON/OFF” button again, the air-conditioner stops.

Note: In the AUTO mode, only some models can set the temperature, and the temperature is set to display 26 °C by default.

★ Cool/Heat operation mode

1. Press the “ON/OFF” button, the air-conditioner starts to operate.
2. Press the “MODE” button, select cool or heat operation mode.
3. By pressing the “+” or “-” button, you can set temperature from 16 °C (60 °F) to 32 °C (90 °F), the display changes as you press the button.
4. By pressing the “SPEED” button, you can select fan speed from Low, Mid, High, Turbo, Auto.
5. Press the “ON/OFF” button again, the air-conditioner stops.

Note: The cold wind type has no heating function.

★ Fan operation mode

1. Press the “ON/OFF” button, the air-conditioner starts to operate.
 2. Press the “MODE” button, select fan operation mode.
 3. By pressing the “SPEED” button, you can select fan speed from Low, Mid, High.
 4. Press the “ON/OFF” button again, the air-conditioner stops.
- Note:** In the Fan mode, the temperature settings is non-effective.

★ Dry operation mode

1. Press the “ON/OFF” button, the air-conditioner starts to operate.
 2. Press the “MODE” button, select dry operation mode.
 3. By pressing the “ + ”or “ - ”button, you can set temperature from 16°C (60°F) to 32°C(90°F), the display changes as you press the button.
 4. Press the “ON/OFF” button again, the air-conditioner stops.
- Note:** In the Dry mode, the speed settings is non-effective.

Usage

★ Fix batteries

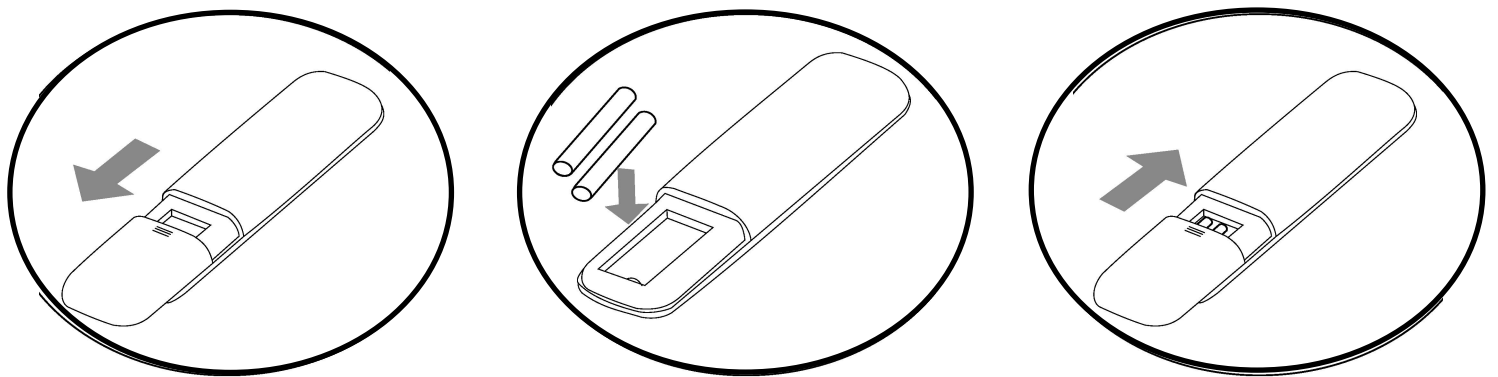

1. Slide to open the battery cover according to the direction indicated by the arrowhead.
2. Insert two brand new batteries (7#), and position the batteries to the right electric poles (+ & -).
3. Put back the battery cover.

ACiQ

The design and specifications are subject to change without prior notice for product improvement. Consult with the sales agency or manufacturer for details. Any updates to the manual will be uploaded to the service website, please check for the latest version.